

## COMPLEMENTARY SILICON PLASTIC POWER TRANSISTORS

... designed for use in general purpose power amplifier and switching applications.

### FEATURES:

\* Collector-Emitter Sustaining Voltage -

$V_{CEO(sus)}$  = 45V(Min)- BD241,BD242

60V(Min)- BD241A,BD242A

80V(Min)- BD241B,BD242B

100V(Min)- BD241C,BD242C

\* DC Current Gain  $h_{FE}$  = 25(Min)@  $I_C = 1.0A$

\* Current Gain-Bandwidth Product  $f_T$  = 3.0 MHz (Min)@  $I_C = 500mA$

NPN	PNP
BD241	BD242
BD241A	BD242A
BD241B	BD242B
BD241C	BD242C

3 AMPERE  
COMPLEMENTARY SILICON  
POWER TRANSISTORS  
45 -100 VOLTS  
40 WATTS

### MAXIMUM RATINGS

Characteristic	Symbol	BD241 BD242	BD241A BD242A	BD241B BD242B	BD241C BD242C	Unit
Collector-Emitter Voltage	$V_{CEO}$	45	60	80	100	V
Collector-Base Voltage	$V_{CBO}$	55	70	90	115	V
Emitter-Base Voltage	$V_{EBO}$	5.0				V
Collector Current - Continuous - Peak	$I_C$	3.0 5.0				A
Base Current	$I_B$	1.0				A
Total Power Dissipation@ $T_C = 25^\circ C$ Derate above $25^\circ C$	$P_D$	40 0.32				W W/ $^\circ C$
Operating and Storage Junction Temperature Range	$T_J, T_{STG}$	-65 to +150				$^\circ C$

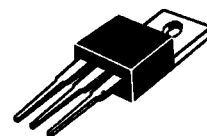

TO-220

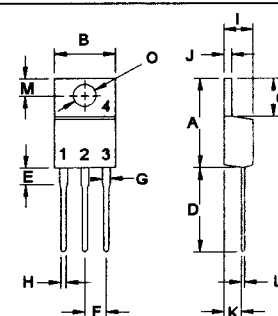

PIN 1.BASE  
2.COLLECTOR  
3.EMITTER  
4.COLLECTOR(CASE)

### THERMAL CHARACTERISTICS

Characteristic	Symbol	Max	Unit
Thermal Resistance Junction to Case	$R_{\theta jc}$	3.125	$^\circ C/W$

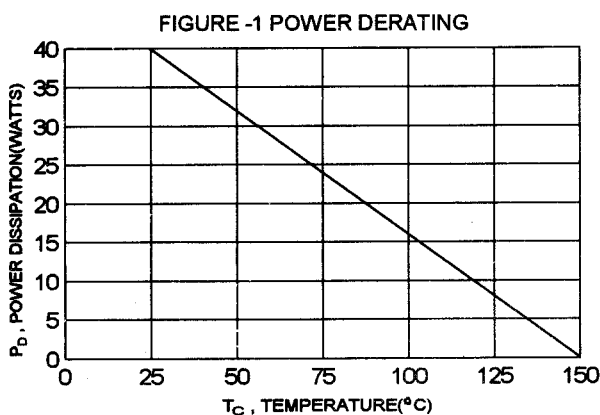

DIM	MILLIMETERS	
	MIN	MAX
A	14.98	15.31
B	9.78	10.42
C	5.01	6.52
D	13.06	14.62
E	3.57	4.07
F	2.42	3.66
G	1.12	1.36
H	0.72	0.96
I	4.22	4.98
J	1.14	1.38
K	2.20	2.97
L	0.33	0.55
M	2.48	2.98
O	3.70	3.90

**ELECTRICAL CHARACTERISTICS (  $T_c = 25^\circ\text{C}$  unless otherwise noted )**

Characteristic	Symbol	Min	Max	Unit
----------------	--------	-----	-----	------

**OFF CHARACTERISTICS**

Collector-Emitter Sustaining Voltage(1) ( $I_C = 30\text{mA}, I_B = 0$ )	BD241,BD242 BD241A,BD242A BD241B,BD242B BD241C,BD242C	$V_{CEO(sus)}$	45 60 80 100	V
Collector Cutoff Current ( $V_{CE} = 30\text{V}, I_B = 0$ ) ( $V_{CE} = 60\text{V}, I_B = 0$ )	BD241/42/41A/42A BD241B/42B/41C/42C	$I_{CEO}$	0.3 0.3	mA
Collector Cutoff Current ( $V_{CE} = 45\text{V}, V_{EB} = 0$ ) ( $V_{CE} = 60\text{V}, V_{EB} = 0$ ) ( $V_{CE} = 80\text{V}, V_{EB} = 0$ ) ( $V_{CE} = 100\text{V}, V_{EB} = 0$ )	BD241/42 BD241A/42A BD241B/42B BD241C/42C	$I_{CES}$	0.2 0.2 0.2 0.2	mA
Emitter Cutoff Current ( $V_{EB} = 5\text{V}, I_C = 0$ )		$I_{EBO}$	1.0	mA

**ON CHARACTERISTICS (1)**

DC Current Gain ( $V_{CE} = 4.0\text{V}, I_C = 1.0\text{A}$ ) ( $V_{CE} = 4.0\text{V}, I_C = 3.0\text{A}$ )		hFE	25 10	
Collector-Emitter Saturation Voltage ( $I_C = 3.0\text{A}, I_B = 600\text{mA}$ )		$V_{CE(sat)}$	1.2	V
Base-Emitter On Voltage ( $I_C = 3.0\text{A}, V_{CE} = 4.0\text{V}$ )		$V_{BE(On)}$	1.8	V

**DYNAMIC CHARACTERISTICS**

Current Gain-Bandwidth Product (2) ( $I_C = 500\text{mA}, V_{CE} = 10\text{V}, f = 1\text{MHz}$ )		$f_T$	3.0	MHz
Small-Signal Current Gain ( $I_C = 500\text{mA}, V_{CE} = 10\text{V}, f = 1\text{KHz}$ )		hfe	20	

(1) Pulse Test: Pulse width =  $300\mu\text{s}$ , Duty Cycle  $\leq 2.0\%$

(2)  $f_T = |h_{fe}| \cdot f_{test}$

DC CURRENT GAIN

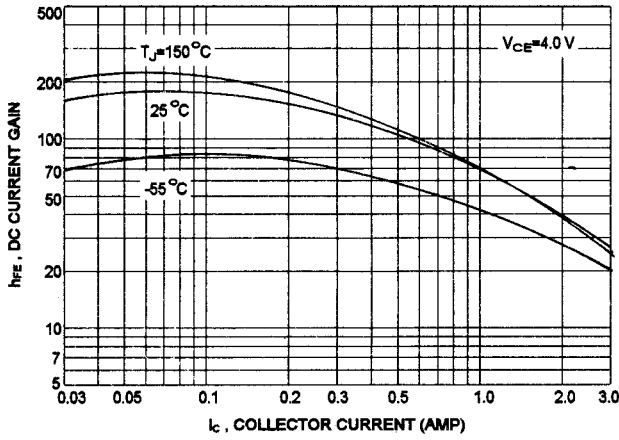

COLLECTOR SATURATION REGION

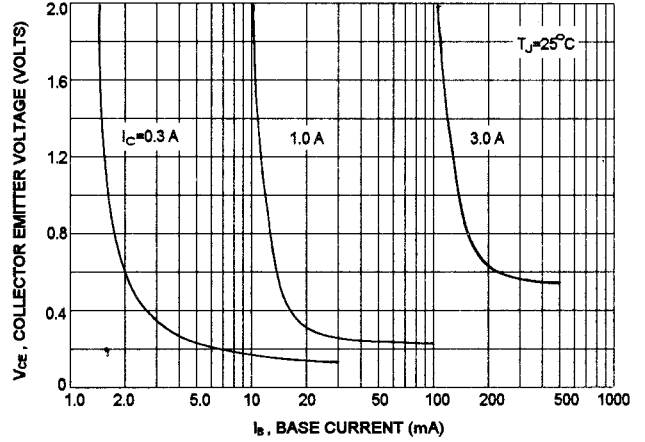

TURN-OFF TIME

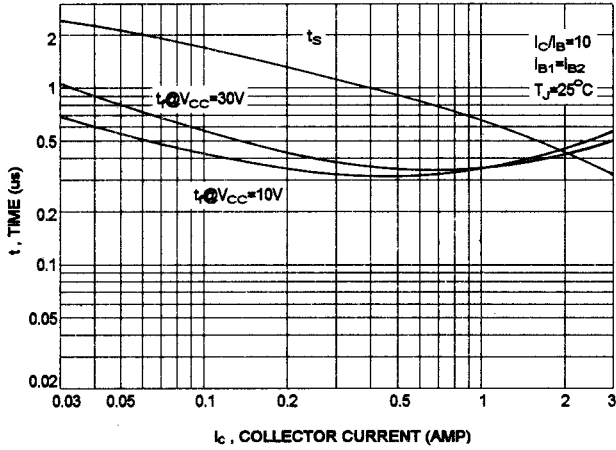

TURN-ON TIME

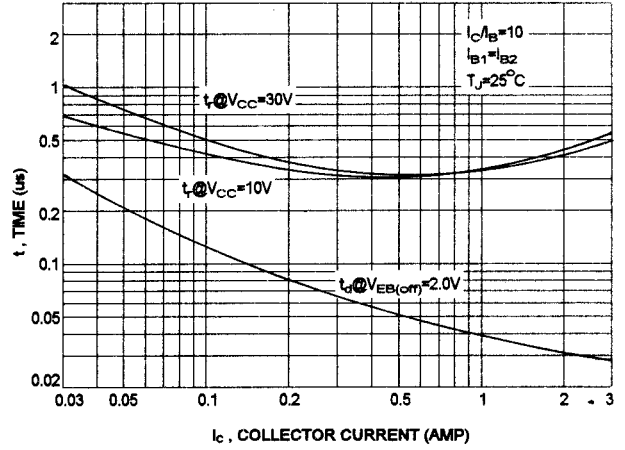

"ON" VOLTAGES

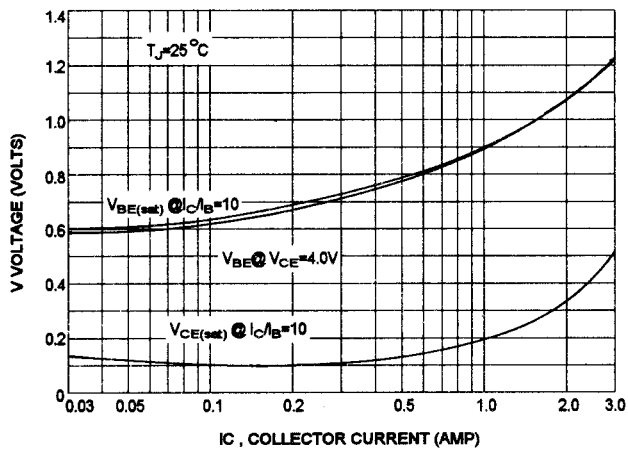

ACTIVE REGION SAFE OPERATING AREA

